

TOYOTA MODEL L2512

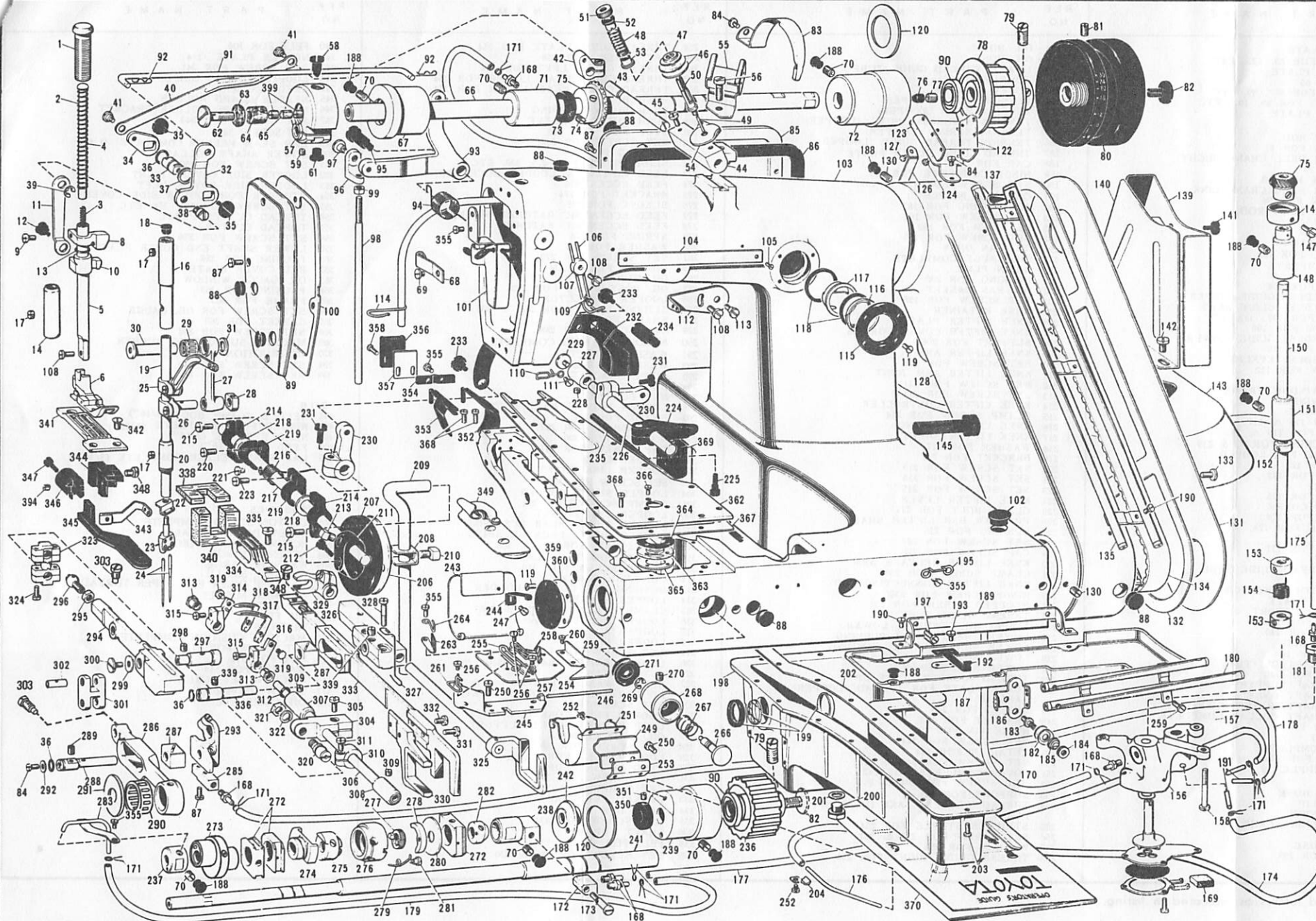

1/4" GAUGE MACHINE

3/16"

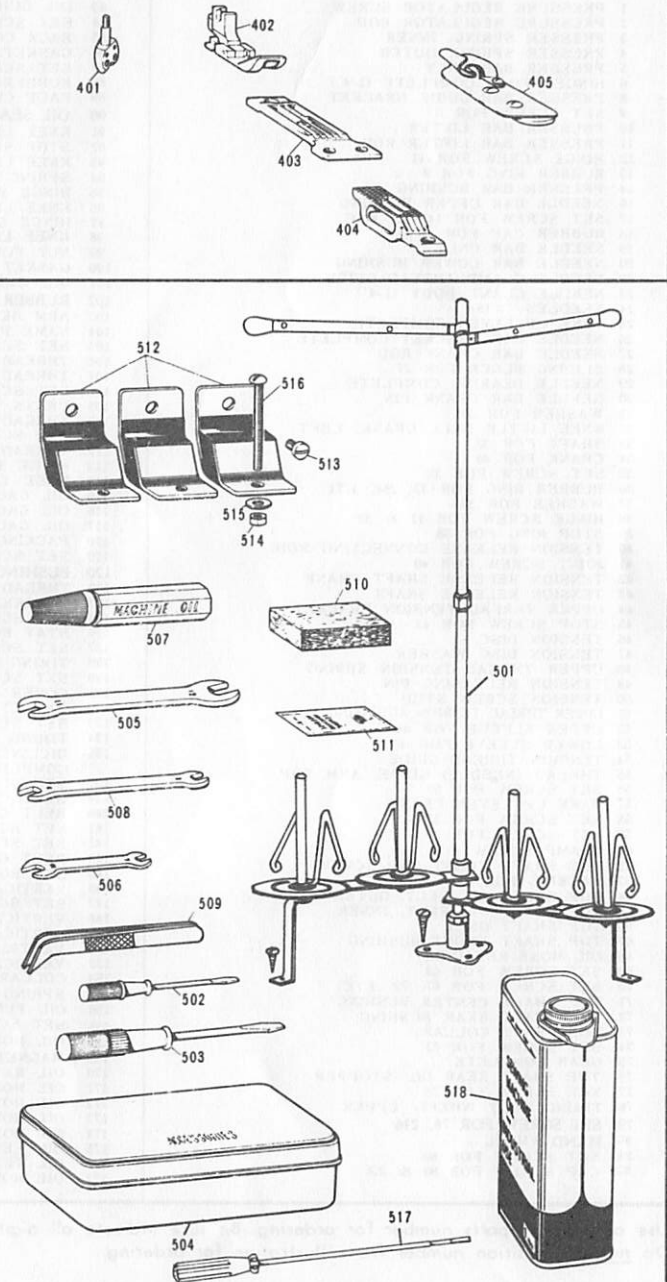

TOYOTA MODEL L2512

REF. NO.	PART NAME	REF. NO.	PART NAME	REF. NO.	PART NAME	REF. NO.	PART NAME	REF. NO.	PART NAME
1	PRESSURE REGULATOR SCREW	83	OIL GUIDE PLATE	178	OIL HOSE	259	THREAD GUIDE PLATE FOR 254	340	FELT FOR 306
2	PRESSURE REGULATOR ROD	84	SET SCREW FOR 83, 123, ETC	179	OIL HOSE	260	SET SCREW FOR 259	341	NEEDLE PLATE (1/4")
3	PRESSER SPRING, INNER	85	BACK COVER PLATE	180	LOWER THREAD GUIDE TUBE COMPLETE	261	THREAD GUIDE, LEFT FOR 254	342	SET SCREW FOR 341
4	PRESSER SPRING, OUTER	86	GASKET FOR 85	181	SCREW FOR 156	263	THREAD GUIDE, REAR, LOWER FOR 254	343	LOOPER THREAD GUIDE
5	PRESSER BAR ONLY	87	SET SCREW FOR 85, 89, ETC	182	TENSION DISC (LOOPER)	264	THREAD GUIDE, REAR, UPPER FOR 254	344	NEEDLE GUARD
6	HINGED FOOT COMPLETE (1/4")	88	RUBBER PLUG FOR 89, 101, ETC	183	TENSION STUD (LOOPER)	266	PUSH BUTTON	345	NEEDLE GUARD HOLDER
8	PRESSER BAR GUIDE BRACKET	89	FACE COVER PLATE	184	TENSION ADJUSTING NUT (LOOPER)	267	PUSH BUTTON SPRING	346	NEEDLE GUARD HOLDER BRACKET
9	SET SCREW FOR 8	90	OIL SEAL	185	TENSION SPRING (LOOPER)	268	PUSH BUTTON SLEEVE	347	SET SCREW FOR 343
10	PRESSER BAR LIFTER	91	KNEE LIFTER ROD	186	TENSION THREAD GUIDE (LOOPER)	269	STOP RING FOR 268	348	SET SCREW 344
11	PRESSER BAR LIFTER ROD	92	STOP SPRING FOR 91	187	THREAD GUIDE COVER PLATE	270	SET SCREW FOR 268	349	LAP SEAM FELLER COMPLETE (1/4")
12	HINGE SCREW FOR 11	93	KNEE LIFTER BELL CRANK, RIGHT	188	CAP FOR 70	271	PACKING FOR 268	350	LOWER SHAFT COLLAR
13	RUBBER RING FOR 8	94	SPRING FOR 93	189	HINGE COMPLETE FOR 187	272	SLIDE BLOCK FOR 325, 330, ETC	351	SET SCREW FOR 350
14	PRESSER BAR BUSHING	95	HINGE SCREW FOR 93	190	SET SCREW FOR 135 & 189	273	FEED LIFTING & LOOPER ECCENTRIC	352	LOOPER SIDE COVER, RIGHT
16	NEEDLE BAR UPPER BUSHING	96	KNEE LIFTER BELL CRANK LINK	191	OIL HOSE NIPPLE	274	FEED ECCENTRIC	353	LOOPER SIDE COVER, LEFT
17	SET SCREW FOR 14, 16, ETC	97	HINGE SCREW FOR 96	192	SET SPRING FOR 187	275	BRACKET FOR 274	354	STOPPER FOR LOOPER SIDE COVER
18	RUBBER CAP FOR 16	98	KNEE LIFTER PUSH ROD	193	SET SCREW FOR 192	276	SLEEVE FOR 275	355	SET SCREW FOR 101, 354, ETC
19	NEEDLE BAR ONLY	99	NUT FOR 98	195	RETAINER FOR 192	277	FEED ECCENTRIC RATCHET WHEEL	356	THREAD CUTTER PLATE
20	NEEDLE BAR LOWER BUSHING	100	GASKET FOR 89	197	SET SCREW FOR 189	278	FEED ECCENTRIC RATCHET	357	THREAD CUTTER
22	NEEDLE CLAMP THREAD GUIDE	101	OIL WICK RETAINER	198	OIL PAN ONLY	279	SPRING FOR 278	358	SET SCREW FOR 356
23	NEEDLE CLAMP BODY (1-4")	102	RUBBER PLUG FOR 103	199	OIL GAUGE COMPLETE	280	WASHER FOR 277	359	LOWER SHAFT END COVER PLATE
24	NEEDLES (#16)	103	ARM BED COMPLETE	200	DRAIN PLUG	281	SET SCREW FOR 279	360	PACKING FOR 359
25	TAKE UP LEVER COMPLETE	104	NAME PLATE	201	PACKING FOR 200	282	LOOPER FEED CAM	362	BED COVER PLATE
26	NEEDLE BAR BRACKET COMPLETE	105	SET SCREW FOR 104	202	OIL PAN GASKET	283	OIL TUBE FOR 237	363	OIL GAUGE WINDOW
27	NEEDLE BAR CRANK ROD	106	THREAD (NEEDLE) GUIDE, UPPER	203	SET SCREW FOR 198	285	OIL HOSE UNION FOR 293	364	PACKING FOR 363
28	SLIDING BLOCK FOR 27	107	THREAD (NEEDLE) GUIDE SEAT	204	HOSE RETAINER	286	LOOPER CONNECTOR	365	FRAME FOR 363
29	NEEDLE BEARING COMPLETE	108	SET SCREW FOR 107, 112, ETC	206	KNEE LIFTER PLATE	287	SLIDING BLOCK FOR 286 & 333	366	SET SCREW FOR OIL GAUGE
30	NEEDLE BAR CRANK PIN	109	PRESS SCREW FOR 106	207	KNEE LIFTER COVER FOR 206	288	SHAFT FOR 287	367	GASKET FOR 362
31	WASHER FOR 30	110	THREAD (NEEDLE) GUIDE, LOWER	208	SUPPORT FOR 206	289	SET SCREW FOR 288	368	SET SCREW FOR 362
32	KNEE LIFTER BELL CRANK, LEFT	111	SET SCREW FOR 110	209	KNEE LIFTER ARM	290	NEEDLE BEARING COMPLETE	369	MACHINE SUPPORTING RUBBER
33	SHAFT FOR 32	112	THREAD (NEEDLE) EYELET	210	SET SCREW FOR 208	291	WASHER FOR 273	370	INSTRUCTION BOOK
34	CRANK FOR 40	113	HINGE SCREW FOR 112	211	KNEE LIFTER ARM JOINT	292	WASHER FOR 288	394	SET SCREW FOR 346
35	SET SCREW FOR 32	114	HOSE CLAMP	212	SET SCREW FOR 211	293	GUIDE BRACKET FOR 286	399	SET SCREW FOR 65
36	RUBBER RING FOR 33, 288, ETC	115	OIL GAUGE WINDOW FRAME	213	SET SCREW FOR 211	294	LOOPER LEVER		
37	WASHER FOR 33	116	OIL GAUGE WINDOW	214	KNEE LIFTER CONTROLLER	295	NUT FOR 296		
38	HINGE SCREW FOR 11 & 32	117	OIL GAUGE BASE	215	CLAMP SCREW FOR 214	296	LOOPER DRIVING BALL STUD		
39	STOP RING FOR 38	118	PACKING FOR 116 & 117	216	KNEE LIFTER SPRING	297	SHAFT FOR 294		
40	TENSION RELEASE CONNECTING ROD	119	SET SCREW FOR 115 & 359	217	KNEE LIFTER SHAFT	298	SET SCREW FOR 297		
41	JOINT SCREW FOR 40	120	BUSHING PACKING FOR 72 & 239	218	WASHER FOR 217	299	WASHER FOR 300		
42	TENSION RELEASE SHAFT CRANK	122	THREAD GUIDE FOR LOOPER	219	BRACKET FOR 217	300	CAP SCREW FOR 297		
43	TENSION RELEASE SHAFT	123	BRACKET FOR 122	220	SET SCREW FOR 219	301	LOOPER LINK		
44	UPPER THREAD TENSION BRACKET	124	SET SCREW FOR 122	221	SET SCREW FOR 216	302	LOOPER LINK SHAFT		
45	STOP SCREW FOR 43	126	STAY FOR 123	222	SET SCREW FOR 219	303	SET SCREW FOR 302		
46	TENSION DISC	127	SET SCREW FOR 126	223	SET SCREW FOR 219	304	LOOPER SHAFT HOLDER		
47	TENSION DISC WASHER	128	TIMING BELT COVER	224	KNEE LIFTER LEVER	305	CLAMP SCREW FOR 304		
48	UPPER THREAD TENSION SPRING	130	SET SCREW FOR 128	225	CLAMP BOLT FOR 224	306	LOOPER SHAFT ONLY		
49	TENSION RELEASING PIN	131	COVER PLATE FOR 128	226	PRESSER BAR LIFTER SHAFT	307	LOOPER SHAFT REAR BUSHING		
50	TENSION SCREW STUD	132	GASKET FOR 131	227	BUSHING FOR 226	308	LOOPER SHAFT FRONT BUSHING		
51	UPPER THREAD TENSION ADJUSTING NUT	133	SET SCREW FOR 131	228	SET SCREW FOR 227	309	SET SCREW FOR 307 & 308		
52	UPPER SLEEVE FOR 48	134	TIMING BELT	229	CAP SCREW FOR 226	310	LOOPER SHAFT COLLAR		
53	LOWER SLEEVE FOR 48	135	INCLINED THREAD GUIDE TUBE COMPLETE	230	KNEE LIFTER RELEASE ARM	311	CLAMP SCREW FOR 310		
54	TENSION THREAD GUIDE	137	STITCH LENGTH INDICATOR	231	CLAMP SCREW FOR 230	312	OIL SEAL FOR 306		
55	THREAD (NEEDLE) GUIDE, ARM TOP	139	BELT COVER PLATE	232	KNEE LIFTER CONNECTING ROD	313	BUSHING FOR LOOPER HOLDER		
56	SET SCREW FOR 55	140	BELT COVER SUPPORT	233	HINGE SCREW FOR 232	314	LOOPER HOLDER, FRONT		
57	TAKE UP LEVER CRANK	141	SET SCREW FOR 139	234	STOPPER SCREW FOR 232	315	CLAMP SCREW FOR 314 & 316		
58	SET SCREW FOR 57	142	SET SCREW FOR 140	235	THREAD GUIDE TUBE	316	LOOPER HOLDER, REAR		
59	SET SCREW FOR 30	143	BELT COVER BED	236	TIMING BELT WHEEL, LOWER	317	LOOPER A		
61	CLAMP SCREW FOR 30	145	SET BOLT FOR 143	237	LOWER SHAFT FRONT BUSHING	318	LOOPER B		
62	TOP SHAFT FRONT CAP SCREW	146	VERTICAL SHAFT OIL TRAY	238	LOWER SHAFT CENTER BUSHING	319	SET SCREW FOR LOOPER		
63	PACKING FOR 62	147	SET SCREW FOR 146	239	LOWER SHAFT REAR BUSHING	320	LOOPER DRIVING BALL STUD		
64	TOP SHAFT OIL FELT, OUTER	148	VERTICAL SHAFT UPPER BUSHING	241	LOWER SHAFT ONLY	321	NUT FOR 320		
65	TOP SHAFT OIL FELT, INNER	150	VERTICAL SHAFT ONLY	242	THREAD (LOOPER) TAKE UP	322	SPRING WASHER FOR 321		
66	TOP SHAFT ONLY	151	VERTICAL SHAFT LOWER BUSHING	243	COVER PLATE FOR THREAD (LOOPER)	323	LOOPER TOGGLE LINK COMPLETE		
67	TOP SHAFT FRONT BUSHING	152	VERTICAL SHAFT COLLAR COMPLETE			324	SET SCREW FOR 323		
68	OIL HOSE RETAINER	153	COLLAR FOR 154			325	LOOPER FEED FORK COMPLETE		
69	SET SCREW FOR 68	154	SPRING JOINT			326	LOOPER FEED SHAFT SUPPORT		
70	SET SCREW FOR 67, 72, ETC	156	OIL PUMP COMPLETE			327	OIL HOSE CLAMP		
71	TOP SHAFT CENTER BUSHING	158	SET SCREW FOR 156			328	SET SCREW FOR 326		
72	TOP SHAFT REAR BUSHING	168	OIL HOSE NIPPLE			329	LOOPER FEED FORK ARM		
73	TOP SHAFT COLLAR	169	MAGNET			330	FEED LIFTING FORK		
74	SET SCREW FOR 73	170	OIL RETURN HOSE			331	SET SCREW FOR 330		
75	GEAR COMPLETE	171	OIL HOSE CLIP			332	SET SCREW FOR 330		
76	TOP SHAFT REAR OIL STOPPER	172	OIL HOSE UNION			333	FORKED FEED BAR		
77	SET SCREW FOR 76	173	OIL HOSE UNION SCREW			334	FEED DOG (1/4")		
78	TIMING BELT WHEEL, UPPER	174	OIL HOSE			335	SET SCREW FOR 334		
79	SET SCREW FOR 78, 236	175	OIL FEED HOSE			336	SHAFT FOR 287		
80	HAND WHEEL	176	OIL TUBE FOR 239			338	FELT FOR 333		
81	SET SCREW FOR 80	177	OIL HOSE			339	SET SCREW FOR 326 & 336		
82	CAP SCREW FOR 80 & 236								

340	FELT FOR 306
341	NEEDLE PLATE (1/4")
342	SET SCREW FOR 341
343	LOOPER THREAD GUIDE
344	NEEDLE GUARD
345	NEEDLE GUARD HOLDER
346	NEEDLE GUARD HOLDER BRACKET
347	SET SCREW FOR 343
348	SET SCREW 344
349	LAP SEAM FELLER COMPLETE (1/4")
350	LOWER SHAFT COLLAR
351	SET SCREW FOR 350
352	LOOPER SIDE COVER, RIGHT
353	LOOPER SIDE COVER, LEFT
354	STOPPER FOR LOOPER SIDE COVER
355	SET SCREW FOR 101, 354, ETC
356	THREAD CUTTER PLATE
357	THREAD CUTTER
358	SET SCREW FOR 356
359	LOWER SHAFT END COVER PLATE
360	PACKING FOR 359
362	BED COVER PLATE
363	OIL GAUGE WINDOW
364	PACKING FOR 363
365	FRAME FOR 363
366	SET SCREW FOR OIL GAUGE
367	GASKET FOR 362
368	SET SCREW FOR 362
369	MACHINE SUPPORTING RUBBER
370	INSTRUCTION BOOK
394	SET SCREW FOR 346
399	SET SCREW FOR 65
	(3/16")
401	NEEDLE CLAMP BODY (3/16")
402	HINGED FOOT COMPLETE (3/16")
403	NEEDLE PLATE (3/16")
404	FEED DOG (3/16")
405	LAP SEAM FELLER COMPLETE (3/16")
	(ACCESSORIES)
501	COTTON STAND COMPLETE
502	SCREW DRIVER, SMALL
503	SCREW DRIVER, LARGE
504	ACCESSORY BOX
505	WRENCH, LARGE
506	WRENCH, SMALL
507	SILICONE OILER FOR UPPER THREAD
508	WRENCH, MIDDLE
509	PINCETTE
510	OIL FELT
511	NEEDLES
512	MACHINE CUSHION COMPLETE
513	SET SCREW FOR 512
514	NUT FOR 516
515	WASHER FOR 514
516	MACHINE SET SCREW
517	SCREW DRIVER LL
518	OIL COMPLETE

Use only exact parts number for ordering. Be sure indicate all digits and letters as indicated in listing.
Do not use position number from illustration for ordering.